



Quick Start Guide



MASTER SERVER

High Performance Music Server

Table of Contents

Product Features	1
Packaging Content	1
Front Panel	2
Rear Panel	2
Preparation Work (1)	3
Preparation Work (2)	3
Advanced Connection Diagram	4
Power On	5
Install Mobile App	5
Use Mobile Device to Control Master Server	6
Device Search Guide	7
Install Applications	8
Application Introduction	9

Product Features

- Dual firmware design prevents the firmware from being damaged during upgrade.
- The dual network port design can connect the network and player at the same time.
- USB Audio Optimizer is an optimized USB audio processing.
- Event triggered system architecture minimizes system load.
- BNC external clock interface is applicable to external clock equipment

Package Contents



Master Server



Power Cord x1



Product Manual x1

Front Panel

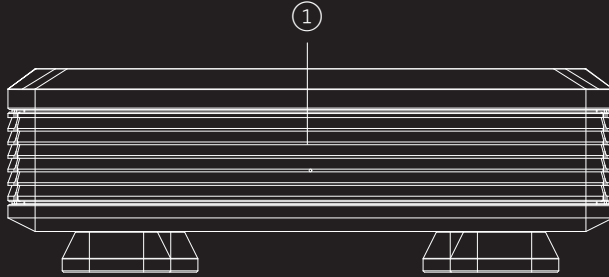

① Power Indicator

When the power is on, the blue light comes on

When the power is off, there is no indicator

Rear Panel

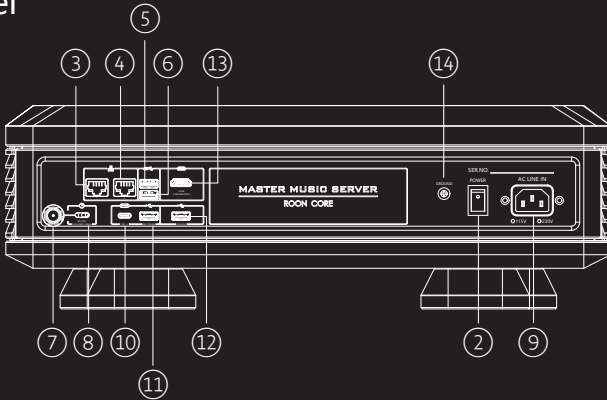

② Power Button

③ Network Port

Supports 1000Mbps Ethernet Network and 100Mbps Ethernet Network

④ Player Port

Supports 1000Mbps Ethernet Network and 100Mbps Ethernet Network

⑤ Capacity Expansion Port

USB3.1 (USB 2.0 compatible)

⑥ Capacity Expansion Port

USB3.1 (USB 2.0 compatible)

⑦ Clock Input

25MHz clock Input port (BNC interface, 50 / 75 ohm impedance auto-detection)

⑧ Clock Selector (slide the switch when the device is turned off)

To use external clock, slides to the side of Clock Input and power cycle

To use internal clock, slides to the side of Internal Clock and power cycle

⑨ AC Input

AC power socket input port

⑩ Type-C Interface

Reserved interface

⑪ Capacity Expansion Port

USB 2.0

⑫ USB Audio Output Port

USB AUDIO Ultra high resolution digital audio output

⑬ Maintenance Port

Only for engineers to maintain equipment, do not use

⑭ Grounding Port

Connect to grounding box

Preparation Work (1)

! Make sure audio devices are all powered off.

Connect Master Server Network port to a Bonn series or WiFi router LAN port with an Ethernet cable.
Connect USB AUDIO port to a USB DAC with the USB cable.

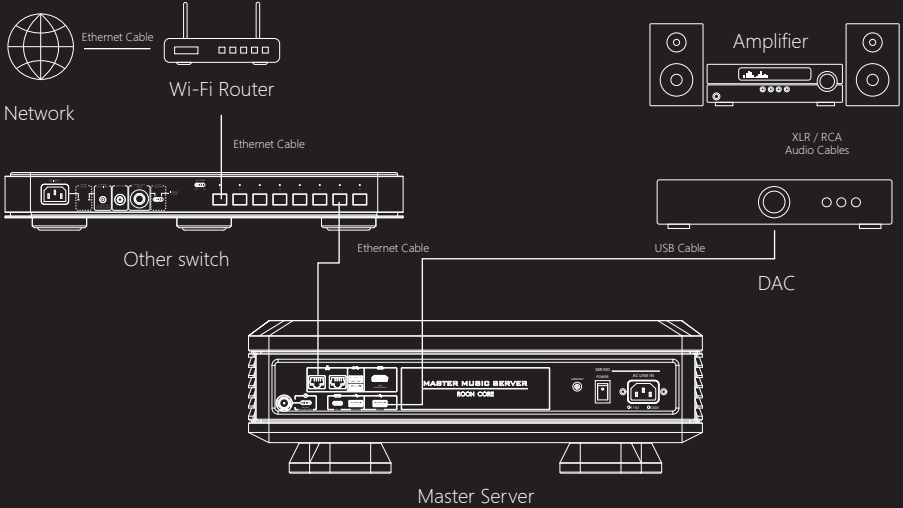

Preparation Work (2)

Connect the power adaptor to the circular power inlet in the rear panel.
Connect the power adaptor to the AC outlet with power cord (Make sure the power cord has been plugged into the power adaptor before plugging into the AC outlet on the wall).

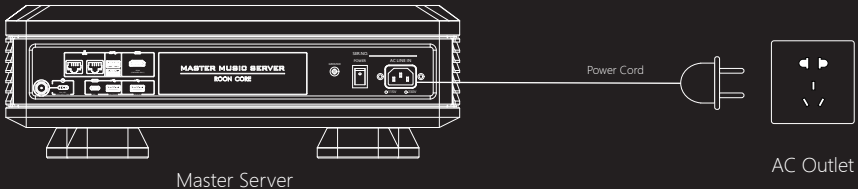

Advanced Connection Diagram

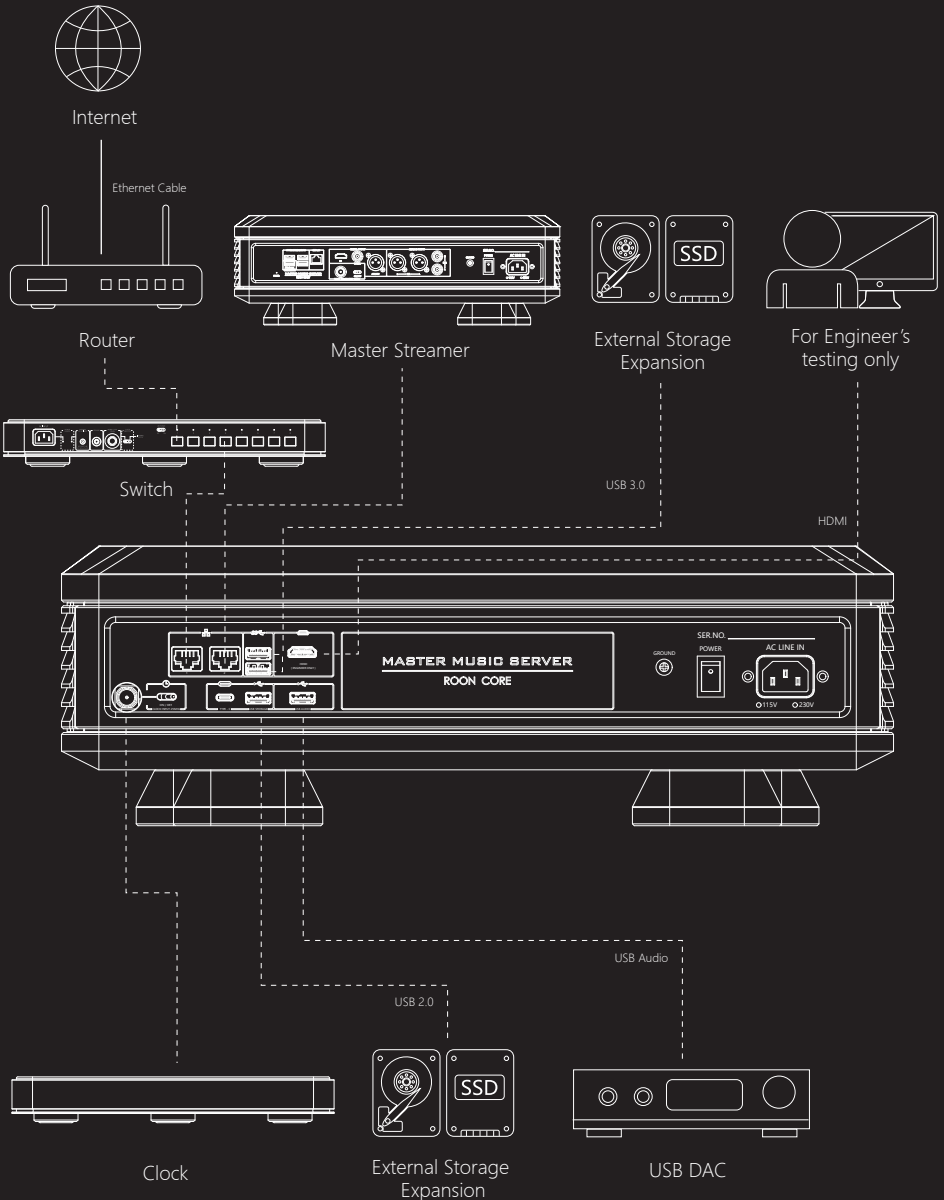

Power On

Power on Master Server by pushing the power button at the rear panel. The power LED will light on.

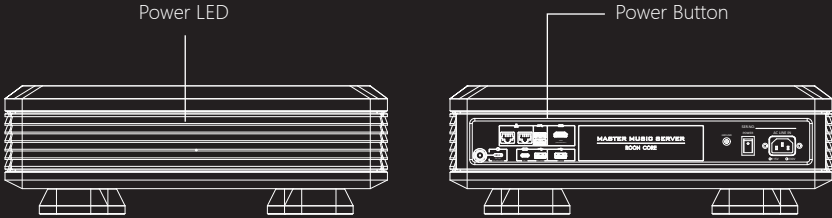

Power on other audio devices

Install "VitOS Manager" App on a Pad or Phone

Use below QR code to install "VitOS Manager" app on a pad or phone.



iPad / iPhone
(iOS)



Android Pad / Phone
(Google Play)



Android Pad / Phone

Use "VitOS Manager" App to Control Master Server

By using "VitOS Manager" app on a iPad/iPhone/Android Pad/Android Phone, which is connected to the same LAN, you are able to discover Master Server, install Roon Server to Master Server, view system status of Master Server, Please refer to the official website for more function instructions <https://telos-audio.com.tw/>.

Use Mobile Device to Control Master Server



Device Search Guide

If the device cannot be found when connecting, click the "Help" button.

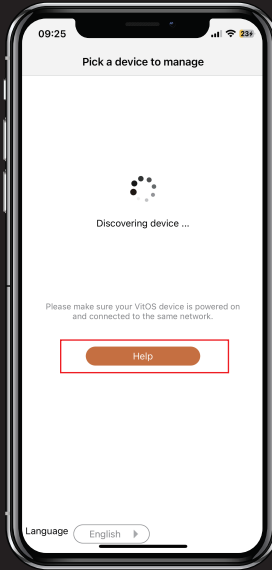

Enter the "Discover Guide" interface, enter the IP address of the Master Server device in the space marked at the bottom of the interface, and then click "Connect".



The connection to Master Server is successful and the VitOS Manager main page is shown.



Install Applications

Before using the application, you need to confirm the installation status of the application. If "Running" is displayed, it means it has been installed. If "Not Installed" appears, click the corresponding application, and then click the "Install" button.

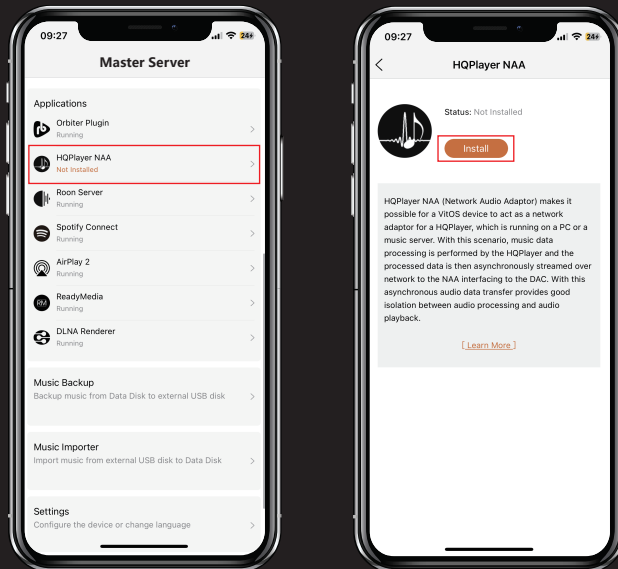

After installing the application, "Downloading" is displayed. Wait until the download is completed to "100%". If the status displays "Running", the installation is successful.

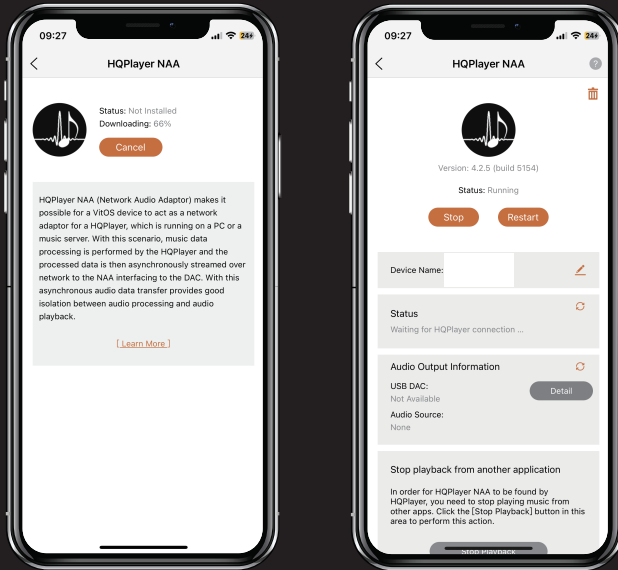

Application Introduction

- Orbiter Plugin:** Orbiter Plugin is an application plug-in that mainly builds music playback operations for VitOS devices. It is also an important program for VitOS
- HQPlayer NAA:** HQPlayer NAA (Network Audio Adapter) enables VitOS devices to act as network adapters for HQPlayer running on a PC or music server. In this case, music data processing is performed by HQPlayer, and the processed data is then streamed asynchronously over the network to the NAA interfaced with the DAC.
- Roon Server:** Roon Server is a music management and playback solution. It can play music through audio streaming and provides rich music library browsing, search and recommendation functions. You can use it via the Roon App.
- Spotify Connect:** To use the functions of Spotify Connect, you need to install or open the Spotify App.
- ReadyMedia:** ReadyMedia (formerly known as MiniDLNA) is a DLNA server for VitOS devices with installed data disks. With ReadyMedia installed on this VitOS device, you can use DLNA-compatible devices or software to browse and play music on the data disk.
- DLNA Renderer:** DLNA Renderer is a music playback application that is compatible with the DLNA/UPnP standard. You can control the DLNA renderer to play music from DLNA servers (such as MinimServer and ReadyMedia) through the DLNA controller.



Trademark Attribution Notice

Windows is a trademark or registered trademarks of Microsoft Corporation in the United States and other countries. iOS is a trademark or registered trademark of Cisco in the U.S. and other countries. Android is a trademark of Google LLC, registered in the U.S. and other countries. Mac and macOS are trademarks of Apple Inc., registered in the U.S. and other countries. Apple is a trademark of Apple Inc., registered in the U.S. and other countries.